

# Marcopia Round 3 - #3014



10W



413lm



Blue



24°

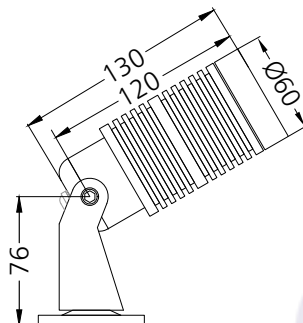
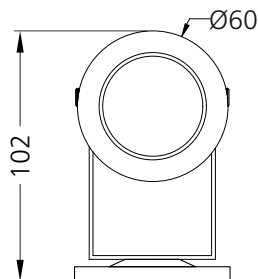

## Photometric Data

Light source	LED - Array	Beam angle	24°
Power (W)	10W	Light output ratio	72%
Delivered lumens	413lm	LED life	L90 B10 Tj75°C
Source lumens	570lm	UGR	<19
Colour temperature (K)	Blue	Operating temperature	-20°C to +50°C
Luminaire efficacy	41.31lm/W	Light distribution	Direct - Symmetric

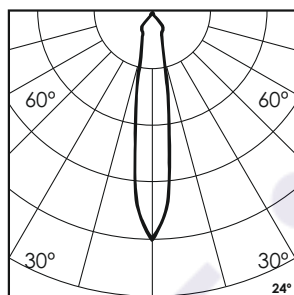



## Technical Data

Mounting detail	Surface Uplighter	Heatsink material	Diecast alm.
Fixing detail	Cowl / Spike / Tree Strap / Mounting Plate	Product weight	528gms
Orientation	Adjustable	Safety class	III
IP rating	IP65	Insulation class	III
IK rating	IK05	Voltage	DC24V
Glow wire test	850°	Driver	Remote - DC24V

## Finish Options

### Body Finish

-  Matt Grey
-  Matt Black
-  Custom RAL Color

## Filter Options



Honeycomb Filter

Above filters can be added to the fixture and need to be ordered as a separate accessory

## Accessories Options



Cowl



Spike



Tree Strap

Above accessories can be added to the fixture and need to be ordered as a separate accessory

## Dimming Options



Remote DMX Decoder

The DMX Decoder requires a 24V CV Driver